

ASSEMBLY

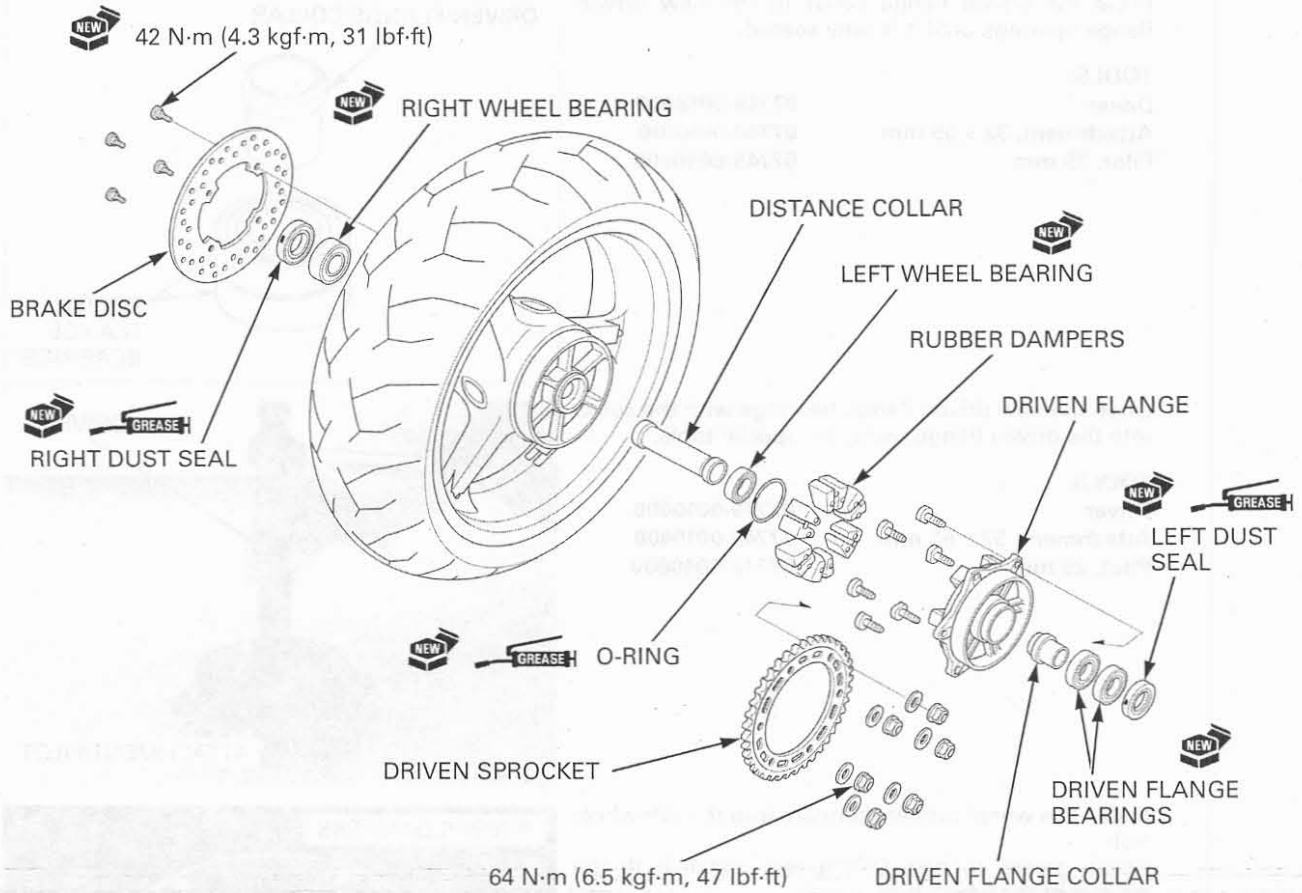

Never install the old bearings, once the bearings has been removed, the bearings must be replaced with new ones.

Wheel bearing installation

- Install the right wheel bearing previously. Drive in a new right bearing squarely, until it is fully seated.

TOOLS:

Driver 07749-0010000
Attachment, 52 x 55 mm 07746-0010400
Pilot, 25 mm 07746-0040600

Install the distance collar

Drive in a new left bearing squarely.

TOOLS:

Driver 07749-0010000
Attachment, 42 x 47 mm 07746-0010300
Pilot, 25 mm 07746-0040600

