

# FUEL SYSTEM (Programmed Fuel Injection)

## INSTALLATION

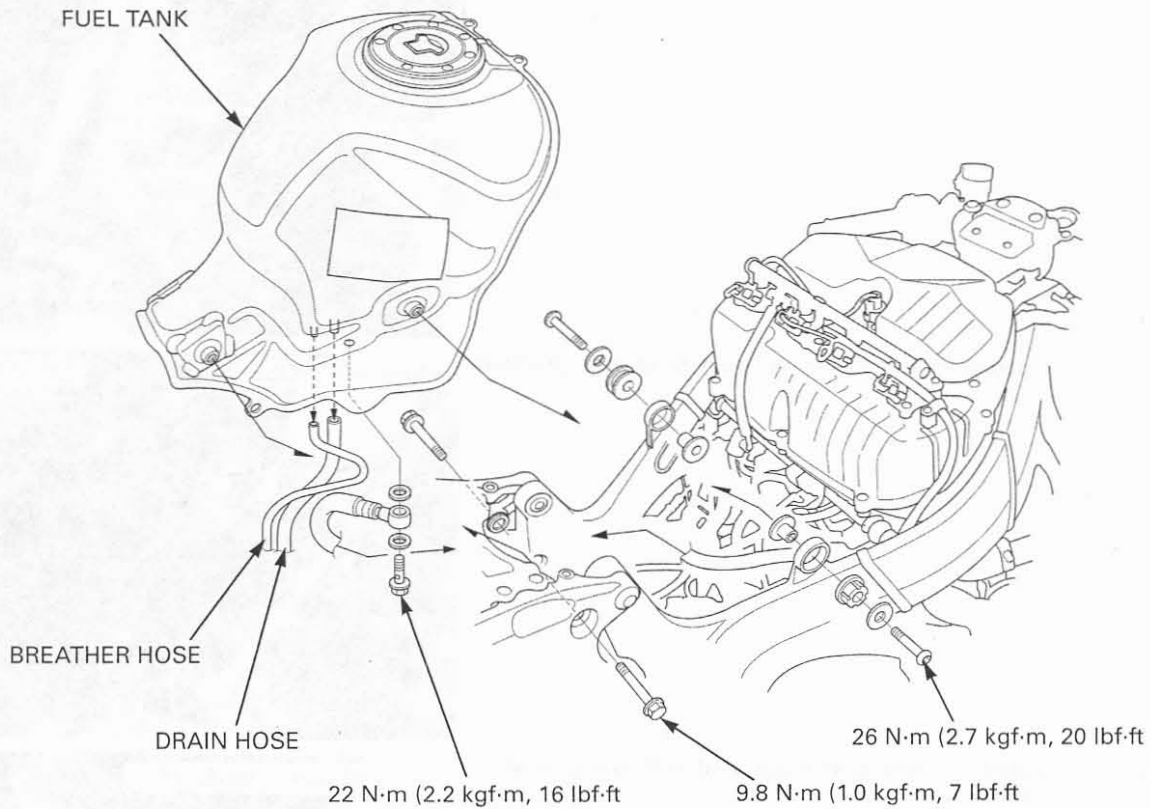

Install the fuel tank, collars and pivot bolts into the frame and tighten the bolts securely.

Open and support the fuel tank (page 4-5).

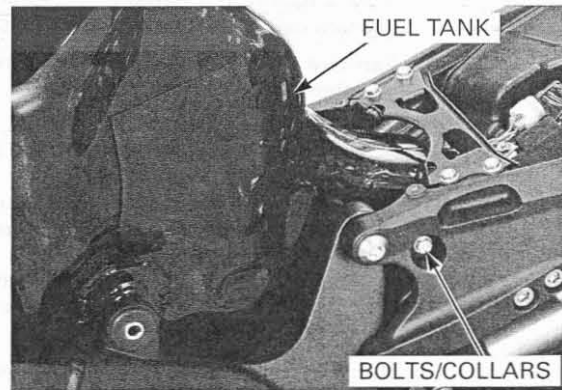

*Align the fuel hose eyelet joint with the stopper on the fuel pump mounting stay.*

Install the new sealing washers and tighten the fuel hose banjo bolt to the specified torque.

**TORQUE: 22 N·m (2.2 kgf·m, 16 lbf·ft)**

