

Suspension Linkage Disassembly/Assembly

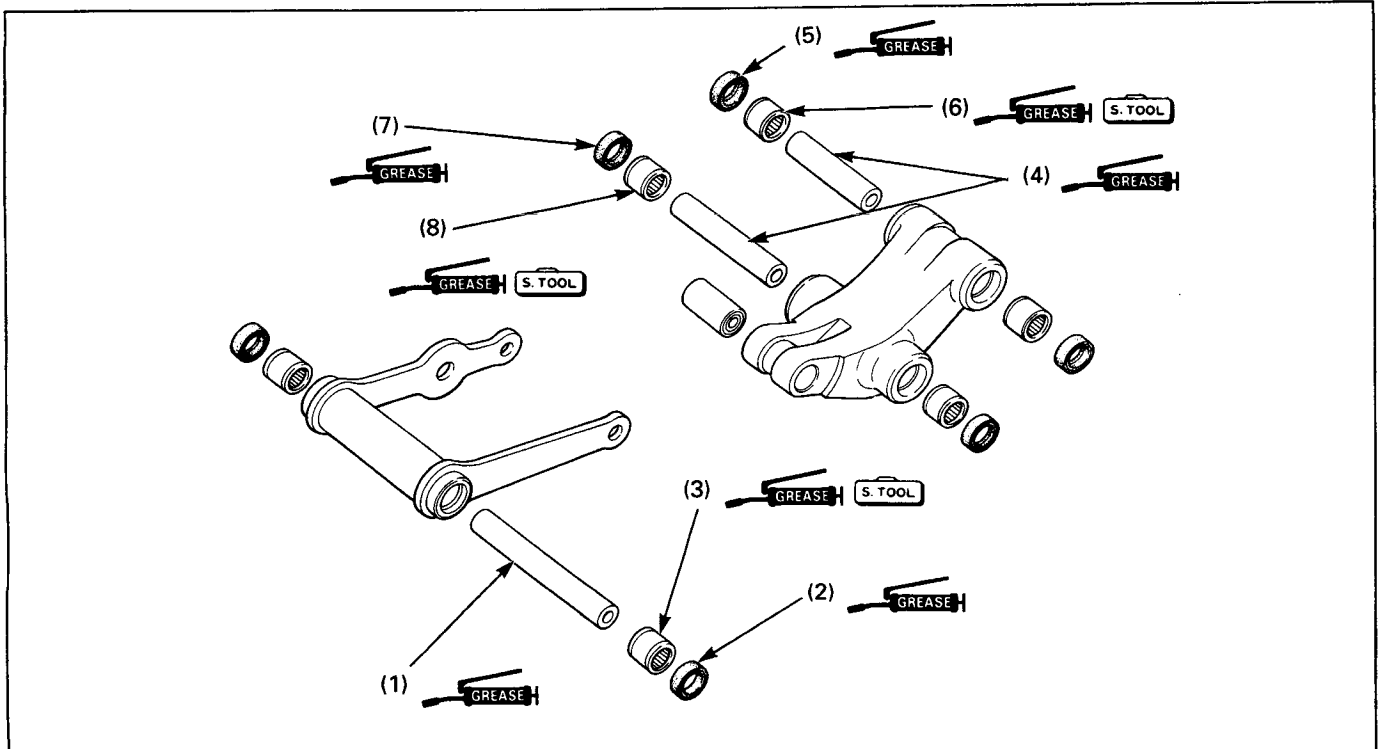

Requisite Service

- Suspension linkage removal/installation (page 12-6)

Procedure	O'ty	Remarks
Removal Order		Installation is in the reverse order of removal.
(1) Shock link pivot collar	1	
(2) Oil seal, 17 x 27 x 5 mm	2	
(3) Needle bearing, 17 x 24 x 25 mm	2	
(4) Shock arm pivot collar	2	
(5) Oil seal, 17 x 27 x 5 mm	2	
(6) Needle bearing, 17 x 24 x 20 mm	2	
(7) Dust seal	2	
(8) Needle bearing	2	