

F 3

F-1

Headlight

Phare

Scheinwerfer

Faro delantero

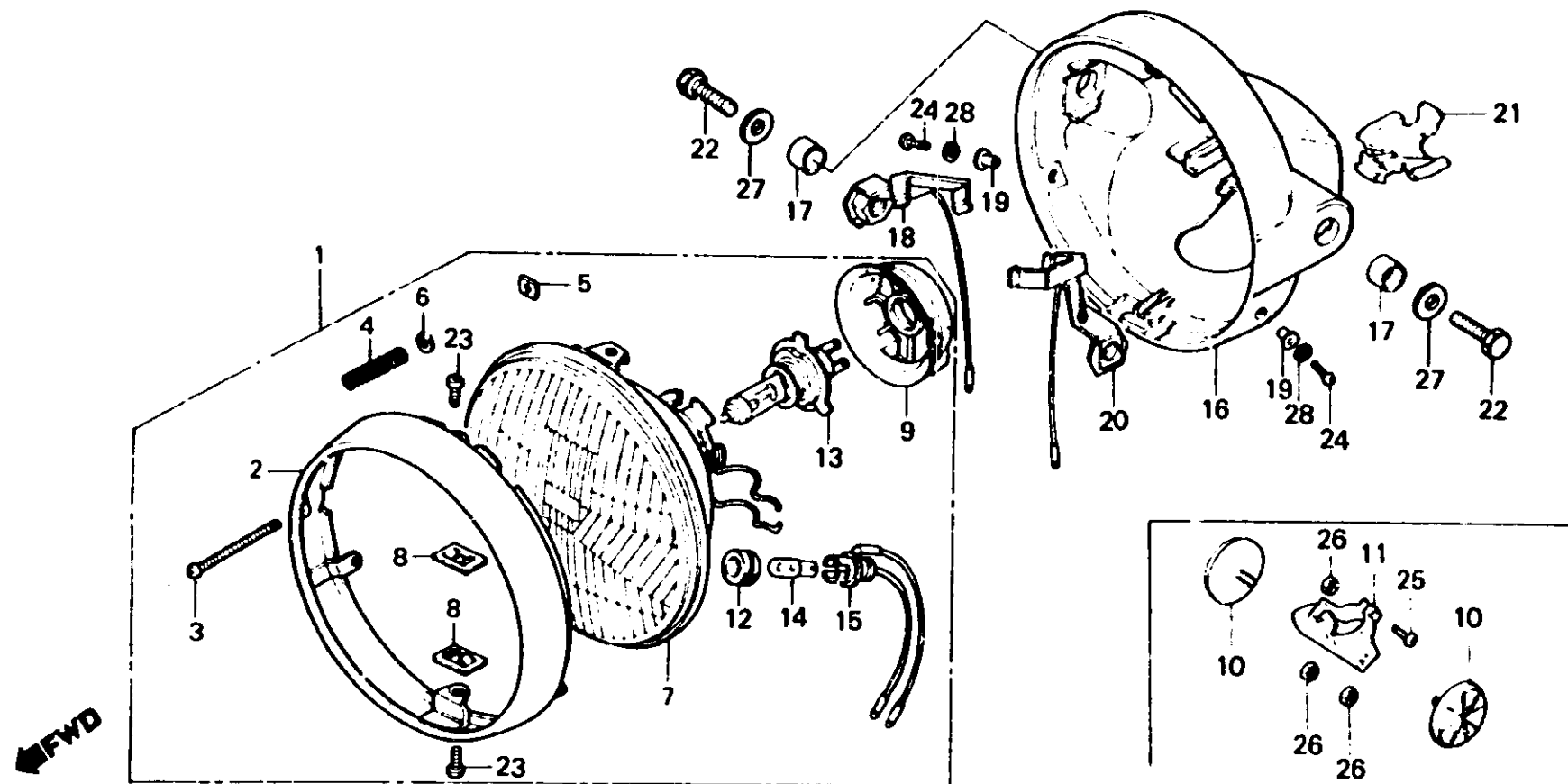

B443 - 117

| Item d'entretien | T.D.R. | N° de réf. | N° de pièce | Description | N° de requis | | | | N° de série | Code de zone |
|------------------|--------|------------|-----------------|---|--------------|--------|---------|--------|-------------|-------------------------|
| | | | | | 250 NDC | 400 Nc | 250 NDc | 400 No | | |
| | | 13 | 34901-390-611 | AMPOULE DE PHARE (12V 45/40W) (LOCAL PROCUREMENT PART) | 1 | 1 | 1 | 1 | | BH,E,ED,H,ND,SW,U,1G,2G |
| | | | 34901-390-621 | AMPOULE DE PHARE (12V 45/40W) (LOCAL PROCUREMENT PART) | 1 | 1 | | 1 | | F |
| | | 14 | 34903-388-611 | AMPOLE DE FEU POSITION (12V 4W) | 1 | 1 | 1 | 1 | | |
| | | 15 | 34904-303-003 | DOUILLE COMP. FEU POSITION | 1 | 1 | 1 | 1 | | |
| | | 16 | 61301-413-003ZA | BOITIER DE PHARE *NH-1* | 1 | 1 | 1 | 1 | | |
| | | 17 | 61302-413-000 | COLLIER DE BOITIER DE PHARE | 2 | 2 | 2 | 2 | | |
| | | 18 | 61303-413-013 | SUPPORT COUPLEUR D. | 1 | 1 | 1 | 1 | | |
| | | 19 | 61304-292-000 | COLLIER DE FIXATION DE PHARE | 2 | 2 | 2 | 2 | | |
| | | 20 | 61304-413-013 | SUPPORT COUPLEUR G. | 1 | 1 | 1 | 1 | | |
| | | 21 | 61306-443-000 | ANNEAU DE BOITIER DE PHARE | 1 | 1 | 1 | 1 | | |
| | | 22 | 92000-12028-06 | BOULON HEX., 12X28 | 2 | 2 | 2 | 2 | | |
| | | 23 | 93500-05008-0H | VIS A TETE CYLINDRIQUE, 6X8 | 2 | 2 | 2 | 2 | | |
| | | 24 | 93500-05016-0B | VIS A TETE CYLINDRIQUE, 6X16 | 2 | 2 | 2 | 2 | | |
| | | 25 | 93500-06016 | VIS A TETE CYLINDRIQUE, 6X16 | 1 | 1 | 1 | 1 | | BH,E,ED,H,ND,SW,U |