

Taking Care of the Unexpected

Sub Fuse Access:

5. Open the fuse case (6) and pull the sub fuse out. If the sub fuse is blown (7), install the spare sub fuse (8).
6. Close the fuse case.
7. Install the left side cover.

If you do not have a replacement fuse with the proper rating for the circuit, install one with a lower rating.

NOTICE

Replacing a fuse with one that has a higher rating greatly increases the chance of damage to the electrical system.

LEFT SIDE

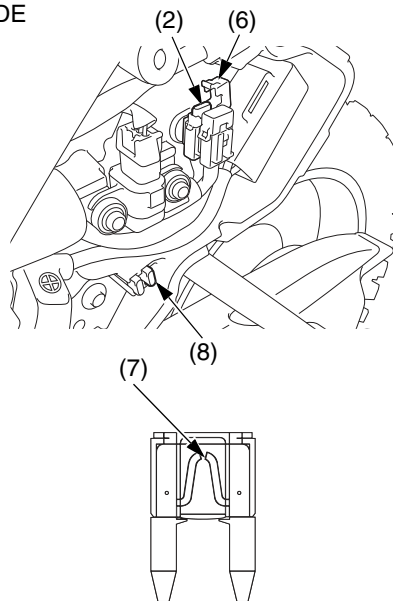

(2) sub fuse
(6) fuse case

(7) blown fuse
(8) spare sub fuse