

Engine Oil

Engine oil quality is the chief factor affecting engine service life. Change the engine oil as specified in the maintenance schedule (page 55).

NOTE:

* Change the engine oil with the engine at normal operating temperature and the motorcycle on its side stand to assure complete and rapid draining.

1. Start the engine and let it idle for a few minutes.
2. Stop the engine, place an oil drain pan under the crankcase. Remove the oil filler cap/dipstick, the drain bolt (1) on the down tube and drain bolt (2) on the left crankcase.
3. After the oil has drained, make sure the sealing washers on the drain plugs are in good condition.

4. Install the drain bolts to the specified torque.

Crankcase drain bolt torque:

25 N·m (2.5 kgf·m , 18 lbf·ft)

Frame drain bolt torque:

39 N·m (4.0 kgf·m , 29 lbf·ft)

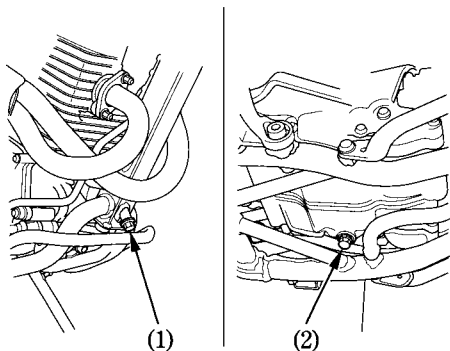

(1) Drain bolt (down tube)

(2) Drain bolt (left crankcase)