

ESSENTIAL INDIVIDUAL COMPONENTS

IGNITION SWITCH

The ignition switch (1) is below the indicator panel.

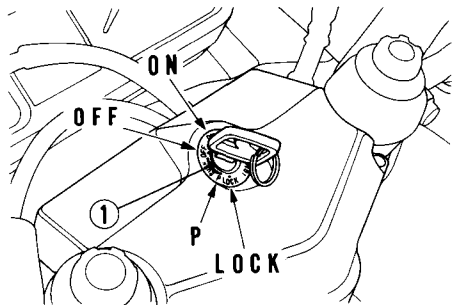

(1) Ignition switch

Key Position	Function	Key Removal
LOCK (steering lock)	Steering is locked. Engine and lights cannot be operated.	Key can be removed
P (parking)	All electric circuits open except for taillight and position light.	Key can be removed
OFF	All electric circuits open. Engine cannot be started.	Key can be removed
ON	All electric circuits closed. Engine and light can be operated.	Key cannot be removed